

REVISIONS			REVISIONS		
DATE	NAME	NO.	DATE	NAME	NO.
DEC: 94	CRAIG F. REMINGTON P.L.S.	23924	DEC: 2013	JAMES A. CONWAY JR. P.L.S.	43235
DEC: 95	CRAIG F. REMINGTON P.L.S.	23924	DEC: 2014	CHARLES L. WALTON JR. P.L.S.	15800
DEC: 97	CHRIS R. REHMANN P.L.S.	17119	DEC: 2015	CHARLES L. WALTON JR. P.L.S.	15800
DEC: 98	CRAIG F. REMINGTON P.L.S.	23924	DEC: 2016	CHARLES L. WALTON JR. P.L.S.	15800
DEC: 99	WILLIAM E. ALBURGER P.L.S.	32106	DEC: 2017	CHARLES L. WALTON JR. P.L.S.	15800
DEC: 2000	WILLIAM E. ALBURGER P.L.S.	32106			
DEC: 2001	WILLIAM E. ALBURGER P.L.S.	32106			
DEC: 2002	PATRICK S. VITARELLI P.L.S.	27895			
DEC: 2003	PATRICK S. VITARELLI P.L.S.	27895			
DEC: 2004	PATRICK S. VITARELLI P.L.S.	27895			
DEC: 2006	PATRICK S. VITARELLI P.L.S.	27895			
DEC: 2007	PATRICK S. VITARELLI P.L.S.	27895			
DEC: 2008	PATRICK S. VITARELLI P.L.S.	27895			
DEC: 2009	PATRICK S. VITARELLI P.L.S.	27895			
DEC: 2010	PATRICK S. VITARELLI P.L.S.	27895			
DEC: 2011	PATRICK S. VITARELLI P.L.S.	27895			
DEC: 2012	JAMES A. CONWAY JR. P.L.S.	43235			

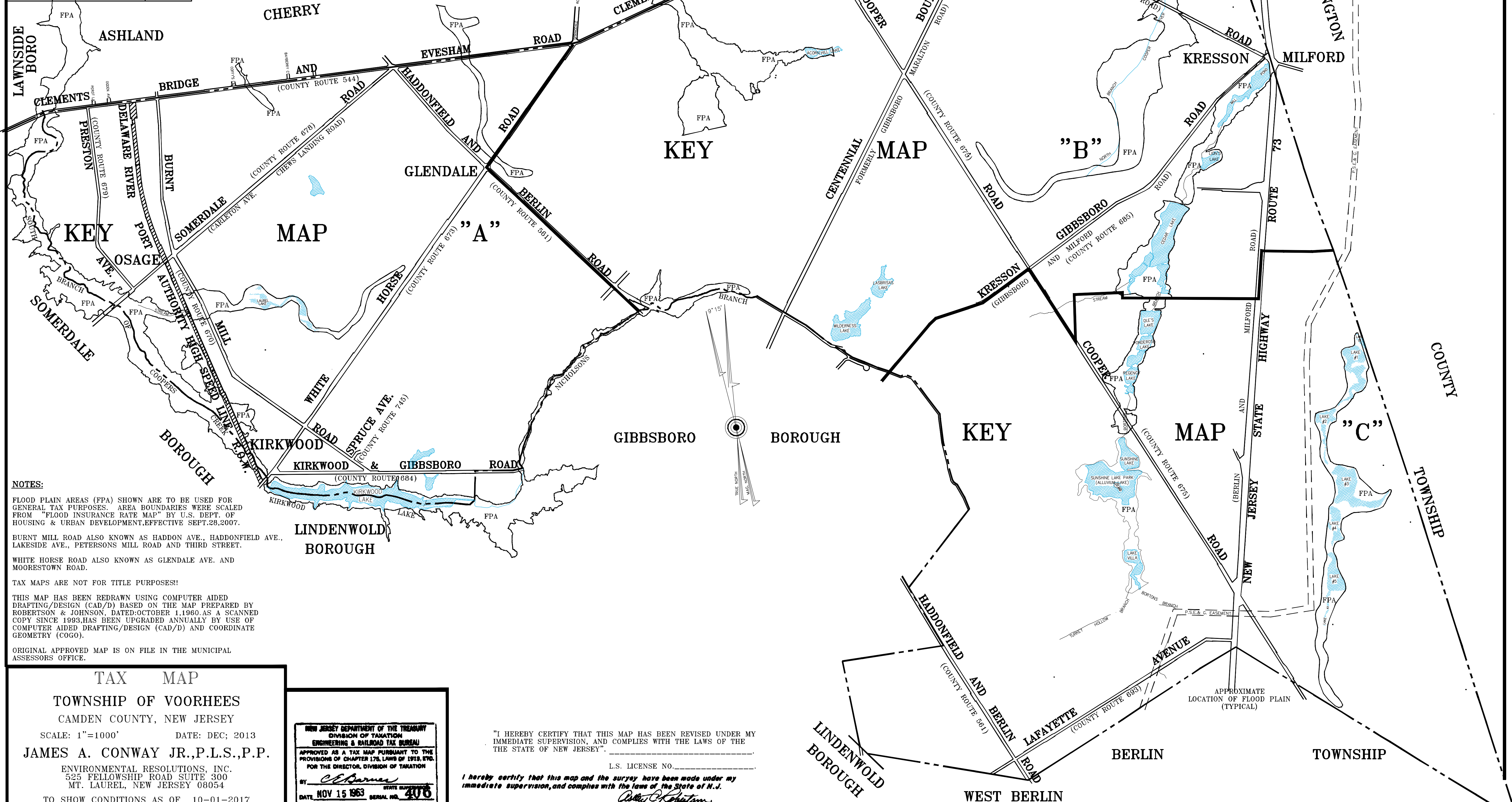

NOTES:

FLOOD PLAIN AREAS (FPA) SHOWN ARE TO BE USED FOR GENERAL TAX PURPOSES. AREA BOUNDARIES WERE SCALED FROM "FLOOD INSURANCE RATE MAP" BY U.S. DEPT. OF HOUSING & URBAN DEVELOPMENT, EFFECTIVE SEPT. 28, 2007.

BURNT MILL ROAD ALSO KNOWN AS HADDON AVE., LAKESIDE AVE., PETERSONS MILL ROAD AND THIRD STREET.

WHITE HORSE ROAD ALSO KNOWN AS GLENDALE AVE. AND MOORESTOWN ROAD.

TAX MAPS ARE NOT FOR TITLE PURPOSES!!

THIS MAP HAS BEEN REDRAWN USING COMPUTER AIDED DRAFTING/DESIGN (CAD/D) BASED ON THE MAP PREPARED BY ROBERTSON & JOHNSON, DATED: OCTOBER 1, 1960. AS A SCANNED COPY SINCE 1993, HAS BEEN UPGRADED ANNUALLY BY USE OF COMPUTER AIDED DRAFTING/DESIGN (CAD/D) AND COORDINATE GEOMETRY (COGO).

ORIGINAL APPROVED MAP IS ON FILE IN THE MUNICIPAL ASSESSORS OFFICE.

TAX MAP

TOWNSHIP OF VOORHEES
CAMDEN COUNTY, NEW JERSEY

SCALE: 1"=1000' DATE: DEC: 2013

JAMES A. CONWAY JR., P.L.S., P.P.

ENVIRONMENTAL RESOLUTIONS, INC.
525 FELLOWSHIP ROAD SUITE 300
MT. LAUREL, NEW JERSEY 08054

TO SHOW CONDITIONS AS OF 10-01-2017

NEW JERSEY DEPARTMENT OF THE TREASURY
DIVISION OF TAXATION
ENGINEERING & RAILROAD TAX BUREAU

APPROVED AS A TAX MAP PURSUANT TO THE PROVISIONS OF CHAPTER 176, LAWS OF 1919, ETC. FOR THE DIRECTOR, DIVISION OF TAXATION

DATE: NOV 15 1963 SERIAL NO. 406

"I HEREBY CERTIFY THAT THIS MAP HAS BEEN REVISED UNDER MY IMMEDIATE SUPERVISION, AND COMPLIES WITH THE LAWS OF THE STATE OF NEW JERSEY".

L.S. LICENSE NO. _____

I hereby certify that this map and the survey have been made under my immediate supervision, and complies with the laws of the State of N.J.

James A. Conway Jr.
P.E. & L.S. LICENSE NO. 3286

File Name: F:\TAX-MAP_CAD-16_2017\pg-key17_TRANS.dwg Saved On: 1/23/2018 10:38:51 AM Saved By: hlivingston