

AVALON COURT (TYPICAL)

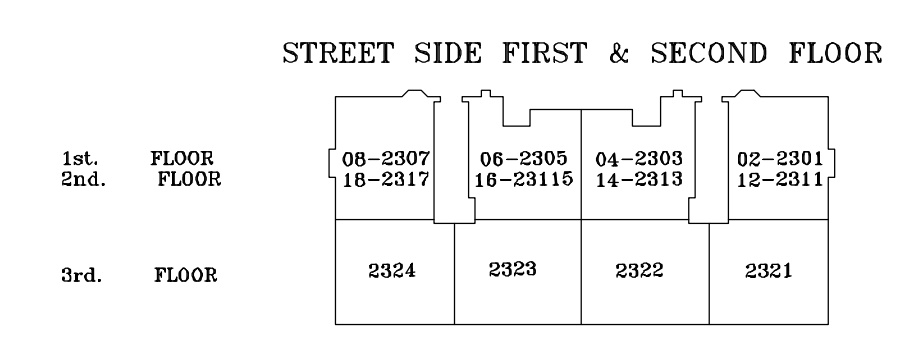

BERWYN COURT (TYPICAL)

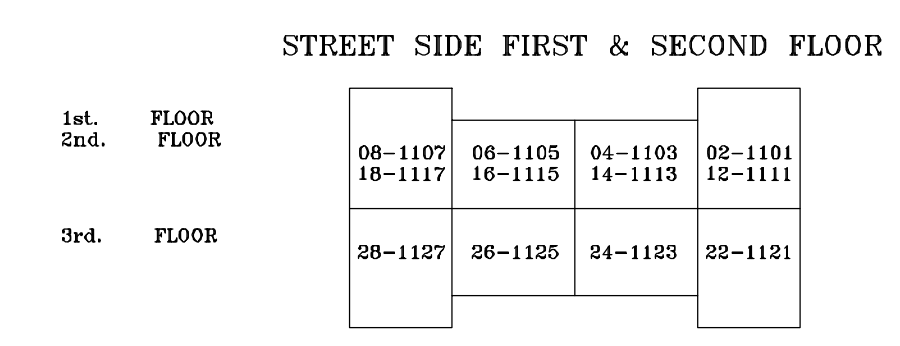

CHELSEA COURT (TYPICAL)

**NOTES:**  
 TAX MAPS ARE NOT FOR TITLE PURPOSES!!  
 THIS MAP HAS BEEN DRAWN USING COMPUTER AIDED DRAFTING/DESIGN (CAD/D) AND COORDINATE GEOMETRY (COGO).

**TAX MAP**  
**TOWNSHIP OF VOORHEES**  
 CAMDEN COUNTY, NEW JERSEY  
 SCALE: 1"=60'      DATE: DEC, 1996  
**CRAIG F. REMINGTON, L.S.**  
 REMINGTON & VERNICK ENGINEERS  
 232 KINGS HIGHWAY EAST  
 HADDONFIELD, NEW JERSEY 08033  
 TO SHOW CONDITIONS AS OF 10-01-2017